

## SOLENOID COIL FEATURES/SPECIFICATIONS

- **STANDARD VOLTAGE:** 12, 24, 36, AND 48, VOLTS D.C.  
115 AND 230 VOLTS A.C.
- **WATTAGE:** ALL 080 SERIES ARE NOMINALIY 16 WATTS AT 68F./20°C.  
ALL 100 SERIES ARE NOMINALLY 22 WATTS AT 68°F./20°C.
- **DUTY RATING:** CONTINUOUS AT 100% VOLTAGE.
- **AMBIENT OPERATING TEMPERATURE:** 212°F./100°C. CONTINUOUS AT NOMINAL VOLTAGE.
- **MAGNET WIRE:** ALL 100 SERIES ARE THERMAL CLASS 200°C., NEMA PUB, NO. MW1000
- **ENCAPSULATING MATERIAL:** THEROPLASTIC POLYESTER (PET).
- **LEAD WIRES:** 18/20 GAUGE X 14"/24" LONG (REFER TO COIL DATA PAGES) MEETS SAE J1128 XLPE, TYPE SXL.
- **A.C. VOLTAGE COILS:** INTERNALLY FULL WAVE RECTIFIED TO SUPPLY THE COIL WINDING WITH D.C. CURRENT THEREFORE THE COIL WINDING HAS NO "INRUSH" CURRENT, SUIT ABLE FOR 50 OR 60 HERTZ (Hz) CYCLE APPLICATIONS. THE RECTIFIERS USED IN A.C. COILS MAY REQUIRE PROTECTION FROM TRANSIENT OVER VOLTAGES EXCEEDING 1000 VOLTS. PROTECT RECTIFIED A.C. COILS BY INSTALLING A COMMERCIALY AVAILABLE NONPOLARIZED SELENIUM DIODE SUPPRESSOR OR METAL-OXIDE VARISTOR ACROSS THE A.C. COIL AS SHOWN.

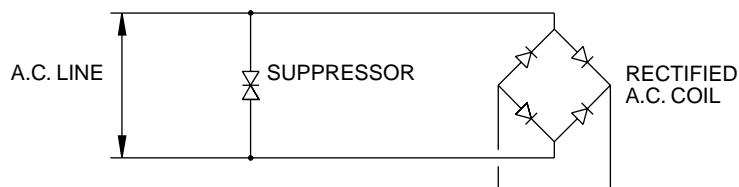

# DELTROL

## SOLENOID COIL DATA 080 SERIES

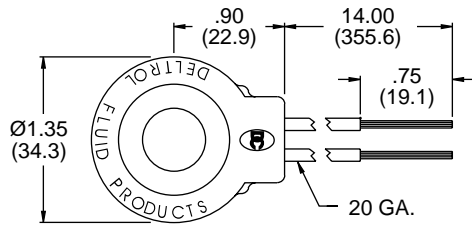

**\*\*D**  
DOUBLE LEADS

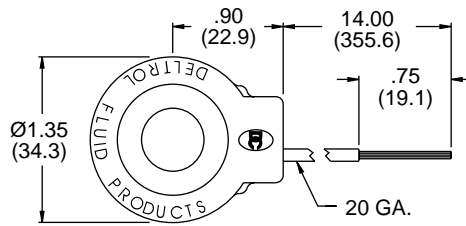

**\*\*S**  
SINGLE LEAD (D\*S ONLY)

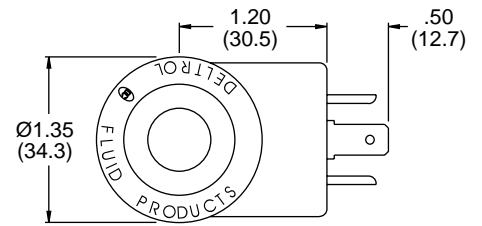

**\*\*H**  
HIRSCHMANN® GSR 200  
(2 POLE + GROUND APPLI-  
ANCE PLUG) TO DIN 43650

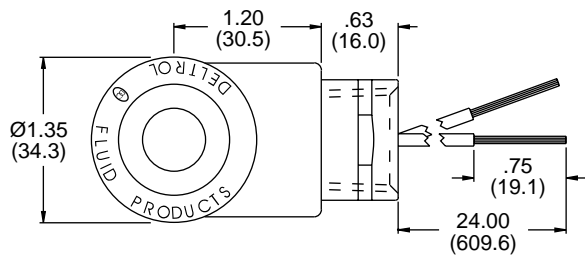

**\*\*C**  
CONDUIT (FEMALE 1/2-14 NPT)

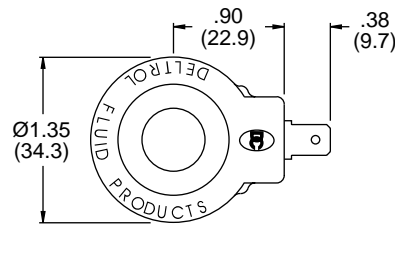

**\*\*B**  
DOUBLE SPADE  
1/4" MALE QUICK-CONNECT  
PER SAE J858A (TYPE 1B)

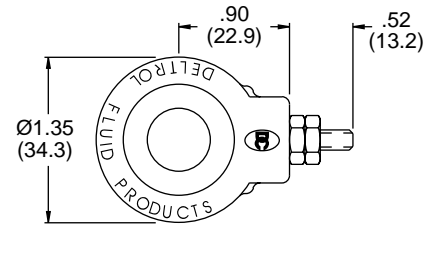

**\*\*E**  
SINGLE STUD  
8-32 MALE STUD  
WITH 2 BRASS NUTS

16 WATT NOMINAL				COIL ASSEMBLY PART NO.					
VOLTS	OHMS	INITIAL CURRENT DRAW (AMPS)	LEAD COLOR	**D	D*S	**H	**C	**B	D*E
12 DC	9	1.33	RED	D1D 10148-51	D1S 10148-52	D1H 10148-72	D1C	D1B 10148-53	D1E 10149-48
24 DC	36	.67	BLUE	D2D 10149-60	D2S	D2H 10148-81	D2C	D2B 10149-62	D2E 10149-61
36 DC	81	.44	GRAY	D3D	X	D3H	D3C	D3B	X
48 DC	144	.33	ORANGE	D4D		D4H	D4C	D4B	
120 AC	△ 827	.15	BLACK	A5D 10148-57		A5H 10148-80	A5C 10148-70	A5B 10148-56	
240 AC	△ 3306	.07	YELLOW	A6D 10158-30		A6H 10148-79	A6C	A6B	

△ RESISTANCE CANNOT BE MEASURED ON A.C. COIL ASSEMBLIES  
OTHER COIL OPTIONS AVAILABLE-CONSULT FACTORY.